

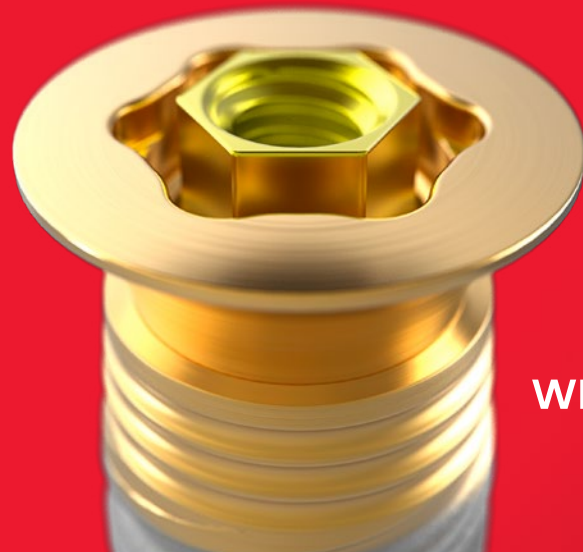

# On1™ concept

Product overview

[nobelbiocare.com/on1](http://nobelbiocare.com/on1)



WE FOLLOW NO  
ONE.

# One base, many restorative options

## On1 Base Xeal incl. handle

	1.75 mm	2.5 mm
NP	300191	300192
RP	300193	300194
WP	300195	300196

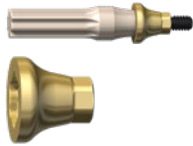

Delivered with the corresponding On1 Clinical Screw

## On1 Clinical Screw

	1.75 mm	2.5 mm
NP	38744	38745
RP	38746	38747
WP	38748	38749



## On1 Base Screwdriver

Machine 21 mm	38752
Manual 25 mm	38753



The On1 Base, IOS Healing Cap and Temporary Abutment are all delivered with a pre-mounted handle for easier placement.

# One base, many restorative options

## Digital workflow

### On1 IOS Healing Cap incl. handle

	4 mm	4.5 mm	5 mm	6 mm
NP		38735		38734
RP		38737		38736
WP	38739		38738	

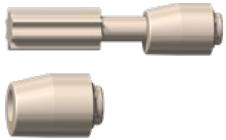

Delivered with the corresponding On1 Prosthetic Screw

- To use as IOS Position Locator for DTX Studio and 3Shape
- To use as Desktop Position Locator for 3Shape

### On1 Desktop Position Locator for Single Abutment

NP / RP / WP	300437
--------------	--------



## Conventional workflow

### On1 Healing Cap

	1.5 mm	2.5 mm
NP	38695	38696
RP	38697	38698
WP	38699	38700



### On1 Impression Coping

	Closed Tray	Open Tray	Open Tray Non-engaging (Bridge)
NP	38725	38728	300367
RP	38726	38729	300368
WP	38727	38730	300369

# One base, many restorative options

## On1 IOS Replica

NP	38740
RP	38741
WP	38742



## On1 IOS Replica Insertion Tool

NP	38201
RP	38203
WP	38204



## On1 Base Replica

NP	38731
RP	38732
WP	38733



## On1 Esthetic Abutment Titanium 0.3 mm

NP	38713
RP	38714
WP	38715



Delivered with the corresponding On1 Prosthetic Screw

## On1 Temporary Abutment incl. handle

	Engaging (Single-unit)	Non-engaging (Bridge)
NP	38701	38702
RP	38703	38704
WP	38705	38706



Delivered with the corresponding On1 Prosthetic Screw



SCAN



IOS



Desktop



DESIGN



DTX  
STUDIO™

3shape 

exocad



MANUFACTURE

In-house milling / printing



For in-house milled crowns use your DTX Studio™ Lab, 3Shape® or exocad software.  
Download the relevant DME at [nobelbiocare.com/openaccess](https://nobelbiocare.com/openaccess)



DTX  
STUDIO™

3shape 

exocad

# One base, many restorative options

## On1 Universal Abutment

	Engaging (Single-unit)		Non-engaging (Bridge)	
	0.3 mm	1.25 mm	0.3 mm	1.25 mm
NP	38707	38708	300361	300362
RP	38709	38710	300363	300364
WP	38711	38712	300365	300366



Delivered with the corresponding On1 Prosthetic Screw and On1 Burn-out Coping

## On1 Prosthetic Screw

NP / RP / WP 38750



## Unigrip Screwdriver Manual

20mm 29148  
 28mm 29149  
 36mm 29150



## Unigrip Screwdriver Machine

20mm 29151  
 25mm 29152  
 30mm 29153  
 35mm 29154



# One base, many restorative options

## On1 Laboratory Prosthetic Screw

NP / RP / WP

38751



## Manual Torque Wrench Prosthetic

29165



## Manual Torque Wrench Adapter

29167



---

## ORDER ONLINE

Order the complete range of our implants and prefabricated prosthetics 24 hours a day through the Nobel Biocare online store.

[nobelbiocare.com/store](https://nobelbiocare.com/store)

---

## ORDER BY PHONE

Call our customer service team, or contact your sales representative.

---

## LIFETIME WARRANTY

On all Nobel Biocare implants including prefabricated prosthetic components. For further information visit:

[nobelbiocare.com/warranty](https://nobelbiocare.com/warranty)

[nobelbiocare.com/on1](https://nobelbiocare.com/on1)



87597 GB 2107 Printed in the EU © Nobel Biocare Services AG, 2021. All rights reserved. Nobel Biocare, the Nobel Biocare logotype and all other trademarks are, if nothing else is stated or is evident from the context in a certain case, trademarks of Nobel Biocare. Please refer to [nobelbiocare.com/trademarks](https://nobelbiocare.com/trademarks) for more information. Product images are not necessarily to scale. All product images are for illustration purposes only and may not be an exact representation of the product. Disclaimer: Some products may not be regulatory cleared/released for sale in all markets. Please contact the local Nobel Biocare sales office for current product assortment and availability. See Instructions For Use for full prescribing information, including indications, contraindications, warnings and precautions.